

Stainless Steel Heavy Duty Cleaners Bucket Sink

Product Code BKTSK

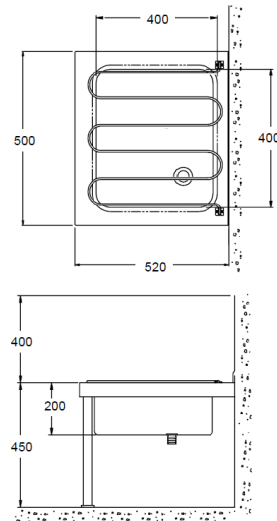

Stainless steel heavy duty cleaners bucket sink. With front support legs, stainless steel hinged bucket grating, and separate splash back. Wall and floor fixing points.

Material:

Manufactured from stainless steel with a satin finish.

Bowl Size:

400mm x 400mm x 200mm deep.

Waste Outlet:

Supplied with a 38mm flush grated waste fitting.

Dimensions:

500mm wide

520mm front to back

200mm deep bowl

450mm high legs

400mm high splashback

Optional Extras:

Cross head wall mounted bib taps.

6 inch lever wall mounted bib taps.

Wall plate elbows (to convert the wall mounted bib taps to exposed water supply).

Plastic 38mm bottle trap