

## Stainless Steel Medium Hand Wash Basin

Product Code WBMED

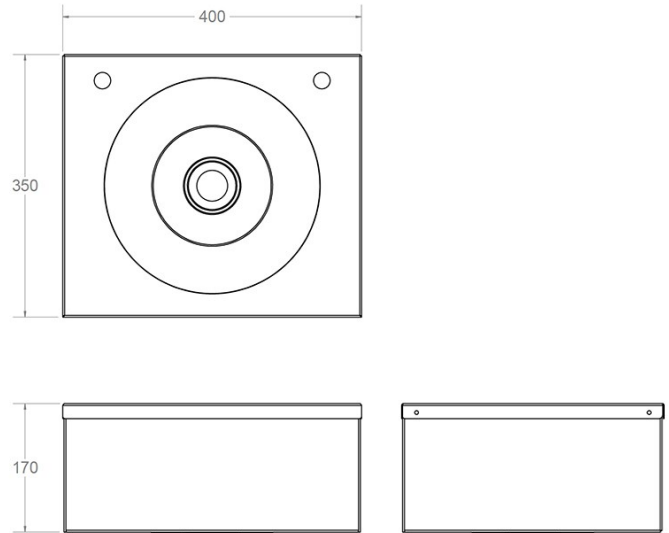

Stainless steel wall mounted medium sized hand wash basin, suitable for separate hand washing facilities for areas with limited space.

**Material:**

Manufactured from grade 304 stainless steel.

**Taps Holes:**

Supplied with two 22mm tap holes.

**Fixings:**

Fitted apron support with integral screw fixing holes.

**Size:**

400mm wide, 350mm front to back, 170mm deep.

**Waste Outlet:**

Supplied with a 1 1/4" (32mm) flush grated waste fitting (no plug or overflow).

**Optional Extras:**

32mm plastic bottle trap.

Chrome plated 32mm bottle trap with waste pipe and wall flange.