

Stainless Steel Drinking Fountain Adult Height Floor Standing

Product Code DFFSA

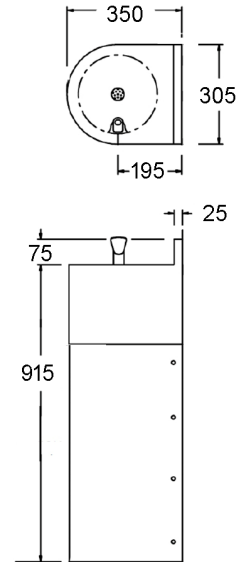

Material:

The adult height drinking fountain is manufactured from 1.6 thick satin polished stainless steel for durability and vandal resistance.

Design:

The floor standing adult height drinking fountain and undershroud has a radius front design to eliminate sharp corners and edges which makes it suitable for use in school and public buildings. The unit incorporates integral wall and floor fixing points which allow the drinking fountain to be easily installed. The undershroud is removable and held in place with security screws.

Fittings:

The drinking fountain comes complete with integral wall fixings, 32mm flush grated waste fitting, standard NSF approved chrome plated bubbler valve, and adult height shroud.



Options:

Optional cup / bottle filler instead of the bubbler valve.
WRAS approved bubbler valve (tap).

Alternative Models Available;

- Wall mounted drinking fountain.
- Wall mounted drinking fountain with undershroud.
- Floor standing junior height drinking fountain.
- Floor standing pedestal drinking fountain.
- Recessed drinking fountain.