

Stainless Steel Drinking Fountain With WRAS Approved bubbler

Product Code DFWH-WRAS

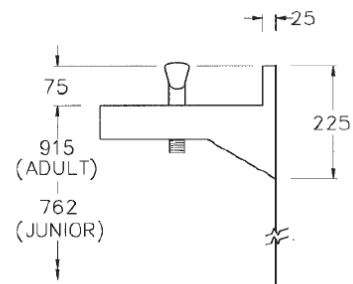
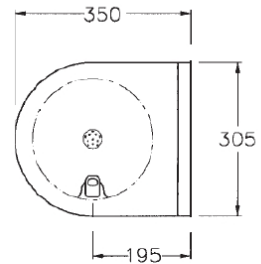

Stainless steel wall mounted drinking fountain with WRAS approved drinking water bubbler (tap). WRAS is the Water Regulations Advisory Scheme and the water bubbler (tap) has been tested and approved to meet these requirements.

Material:

The drinking fountain is manufactured from 1.6 thick satin polished stainless steel for durability and vandal resistance.

Design:

The drinking fountain has a radius front design to eliminate sharp corners and edges which makes it suitable for use in school and public buildings. The unit incorporates integral wall fixing brackets which allow the drinking fountain to be easily installed at adult or junior height.

Fittings:

The drinking fountain comes complete with integral wall fixing brackets, 32mm flush grated waste fitting, and WRAS approved chrome plated bubbler valve.

Options:

32mm plastic bottle trap

32mm chrome plated bottle trap with waste pipe and wall flange.

WASHWARE ESSENTIALS LTD

Kestrel Court, Harbour Road, Portishead, Bristol BS20 7AN, Phone: 01275 390603

Web: www.washwareessentials.co.uk E-mail: enquiries@washwareessentials.co.uk